

Huiderui

Lithium

Cell Type CR123A/CR17345

Specification

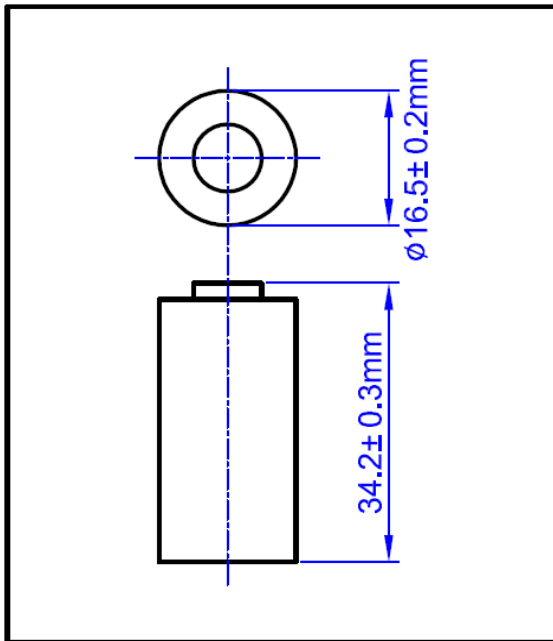

| | | |
|--------------------------------------|----------|------------|
| Nominal Voltage | | 3.0V |
| Dimensions (Max.) | Diameter | 17.0mm |
| | Height | 34.5mm |
| Ref. Weight | | 16.5g |
| Nominal Capacity (Ave.) | | 1600mAh |
| Continuous Standard Load | | 1mA |
| Cut off Voltage | | 2.0V |
| Maximum Continuous Discharge Current | | 1500mA |
| Maximum Pulse Discharge Current | | 3500mA |
| Operating Temperature | | -40~+70*°C |

Discharge Characteristics

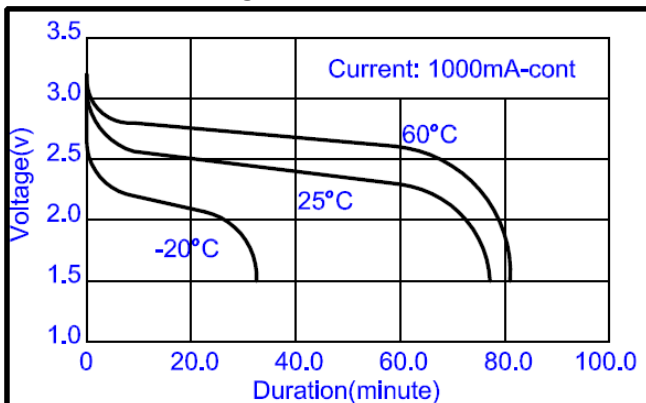

Discharge Characteristics

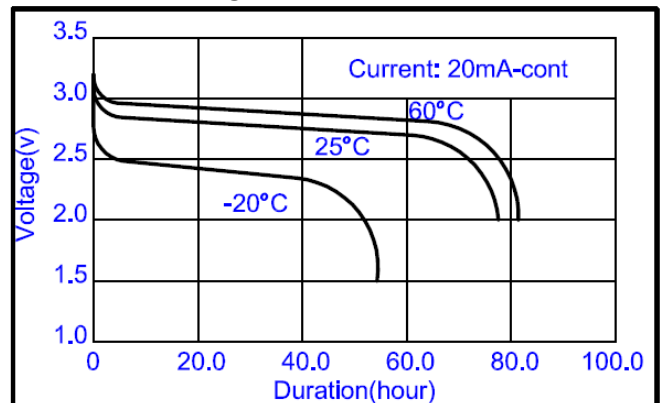

Pulse Discharge Characteristics

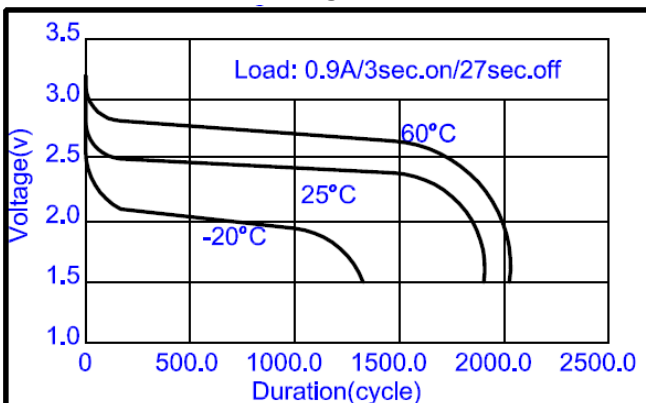

Discharge Characteristics

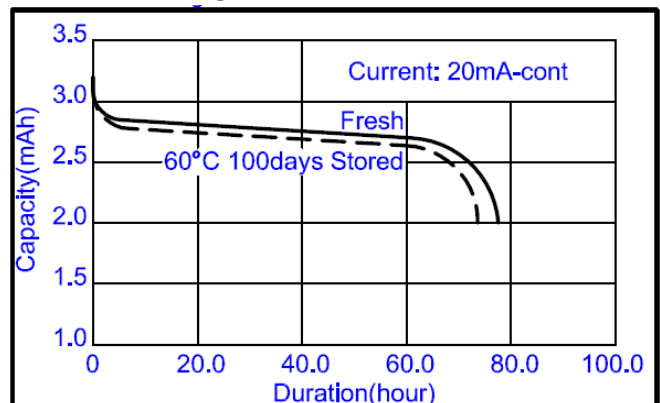

* Please consult Huiderui for use below and above -20°C to +60°C.

WARNING:

- Do not charge, disassemble, heat above 100°C or incinerate.
- Do not mix fresh batteries and used batteries or other types of battery together.
- Do not short circuit.

This information is generally descriptive only and is not intended to make or imply any representation, guarantee or warranty with respect to any cells and batteries. Cell and battery designs/specifications are subject to modification without notice. Contact Huiderui for the latest information.